

Камера высокого разрешения

xWatch

Технические характеристики

Архангельск (8182)63-90-72
Астана +7(7172)727-132
Белгород (4722)40-23-64
Брянск (4832)59-03-52
Владивосток (423)249-28-31
Волгоград (844)278-03-48
Вологда (8172)26-41-59
Воронеж (473)204-51-73
Екатеринбург (343)384-55-89
Иваново (4932)77-34-06
Ижевск (3412)26-03-58
Казань (843)206-01-48
Калининград (4012)72-03-81
Калуга (4842)92-23-67
Кемерово (3842)65-04-62
Киров (8332)68-02-04

Краснодар (861)203-40-90
Красноярск (391)204-63-61
Курск (4712)77-13-04
Липецк (4742)52-20-81
Магнитогорск (3519)55-03-13
Москва (495)268-04-70
Мурманск (8152)59-64-93
Набережные Челны (8552)20-53-41
Нижний Новгород (831)429-08-12
Новокузнецк (3843)20-46-81
Новосибирск (383)227-86-73
Орел (4862)44-53-42
Оренбург (3532)37-68-04
Пенза (8412)22-31-16
Пермь (342)205-81-47
Ростов-на-Дону (863)308-18-15

Рязань (4912)46-61-64
Самара (846)206-03-16
Санкт-Петербург (812)309-46-40
Саратов (845)249-38-78
Смоленск (4812)29-41-54
Сочи (862)225-72-31
Ставрополь (8652)20-65-13
Тверь (4822)63-31-35
Томск (3822)98-41-53
Тула (4872)74-02-29
Тюмень (3452)66-21-18
Ульяновск (8422)24-23-59
Уфа (347)229-48-12
Челябинск (351)202-03-61
Череповец (8202)49-02-64
Ярославль (4852)69-52-93



xWatch surveillance camera

AutoFlame flame detectors
Product Datasheet

Features

xWatch camera

- Low cost surveillance of any flame, gas, or toxic hazard location
- Easy connection to a video switcher using twisted pair wiring
- Use existing wiring if suitable
- Easy retrofit into standard C7050 housing
- Simple no tool exchange of the tube module to camera
- Compact housing for easy installation in small spaces

xWatch/Flame detector combination

- Combines high resolution colour video surveillance and flame detection
- Views the same 90 degree cone of vision as the flame detector
- Combine with any X-series flame detector
- Superior false alarm rejection
- Real verification of detection capability with automatic and magnetic optical integrity
- Combine with detector system upgrades in remaining unused detector locations
- Compatible with LON based detectors
- Ideally suited for remote and/or inaccessible areas
- Informed, appropriate response to incidents
- Pre- and post-event analysis of video recording

Description

The xWatch surveillance camera produces a high-resolution colour video picture using a camera module that is mounted inside an explosion-proof NEMA 4X rated housing. The device's explosion-proof rating makes it suitable for Class I, Div.1, Groups B, C and D locations. xWatch can be used alone or in combination with fire and gas detectors in any application that requires CCTV surveillance capabilities.



The xWatch can be used in any of three configurations:

- xWatch can be used as a stand alone device to perform typical CCTV functions.
- An xWatch camera module can be retrofitted in place of the UV tube module in an existing C7050 Flame Detector to provide basic visual information.
- xWatch can be attached directly to any of the AutoFlame X-series line of flame detectors through a factory installed integral connection adapter. With this arrangement, the camera views the same protected area as the detector.

In the event of a fire or gas alarm, the operator can immediately view the monitored area to determine whether personnel are present and safe. An accurate evaluation of the hazard's size, nature, location and severity can be determined quickly and safely.

Using video recording equipment, the video image of the incident can provide information for analyzing what happened before, during and after the event.

Technical specifications	
Operating temperature	-20 to +70°C
Hazardous location rating	-40 to +75°C
Storage temperature	-30 to +80°C
Relative humidity	5 to 95 % non-condensing
Ingress protection	NEMA/Type 4X
Sensor	Colour low light CCD
Resolution	NTSC: 768 by 494 pixels, 570 lines of resolution PAL: 752 by 582 pixels, 570 lines of resolution
Video output	NTSC or PAL two wire twisted pair
Shutter	Electronic shutter, 1/60 – 1/100,000 second
Operating voltage	24 VDC nominal, 18 to 30 VDC
Power consumption	2,8 W
Field of view	90 degrees
User interface	Conventional off-the-shelf video switchers and controllers can be used for the interface.
Housing	Aluminum or 316 stainless steel
Shipping weight	Aluminum: 0.6 kg (1.2 pounds) Stainless steel: 1.0 kg (2.2 pounds)
Certifications FM/CSA:	FM/CSA: Class I, Div. 1 Groups B, C, and D (T5) Class II/III, Div. 1 Groups E, F, and G (T5) NEMA/Type 4X. CENELEC: 1725 II 2 G (Pending) Ex d IIC T5 FM 07ATEX0053 T5 (Tamb = -40 °C to +75 °C) IP66

Part number	Description
116-009585-001	xWatch surveillance camera, aluminium
116-009587-001	xWatch surveillance camera, stainless steel

Dimensions mm (inches)

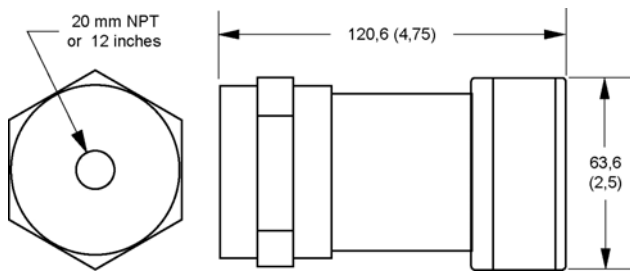

System block diagram

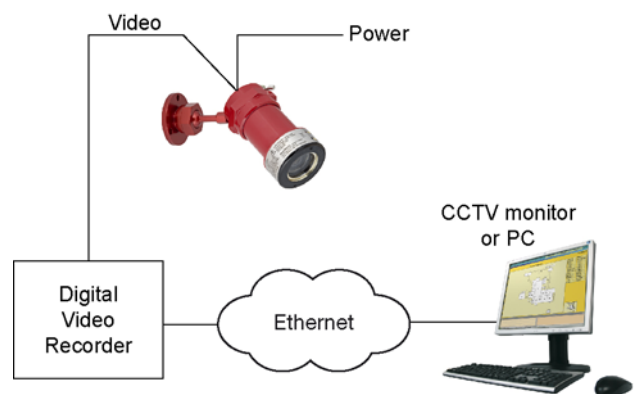

По вопросам продаж и поддержки обращайтесь:

Архангельск (8182)63-90-72
Астана +7(7172)727-132
Белгород (4722)40-23-64
Брянск (4832)59-03-52
Владивосток (423)249-28-31
Волгоград (844)278-03-48
Вологда (8172)26-41-59
Воронеж (473)204-51-73
Екатеринбург (343)384-55-89
Иваново (4932)77-34-06
Ижевск (3412)26-03-58
Казань (843)206-01-48
Калининград (4012)72-03-81
Калуга (4842)92-23-67
Кемерово (3842)65-04-62
Киров (8332)68-02-04

Краснодар (861)203-40-90
Красноярск (391)204-63-61
Курск (4712)77-13-04
Липецк (4742)52-20-81
Магнитогорск (3519)55-03-13
Москва (495)268-04-70
Мурманск (8152)59-64-93
Набережные Челны (8552)20-53-41
Нижний Новгород (831)429-08-12
Новокузнецк (3843)20-46-81
Новосибирск (383)227-86-73
Орел (4862)44-53-42
Оренбург (3532)37-68-04
Пенза (8412)22-31-16
Пермь (342)205-81-47
Ростов-на-Дону (863)308-18-15

Рязань (4912)46-61-64
Самара (846)206-03-16
Санкт-Петербург (812)309-46-40
Саратов (845)249-38-78
Смоленск (4812)29-41-54
Сочи (862)225-72-31
Ставрополь (8652)20-65-13
Тверь (4822)63-31-35
Томск (3822)98-41-53
Тула (4872)74-02-29
Тюмень (3452)66-21-18
Ульяновск (8422)24-23-59
Уфа (347)229-48-12
Челябинск (351)202-03-61
Череповец (8202)49-02-64
Ярославль (4852)69-52-93

Единый адрес для всех регионов: acn@nt-rt.ru || www.autronica.nt-rt.ru